

RYOBI®

RLT30CESA / RBC30SESA

STRING TRIMMER / BRUSHCUTTER

OPERATOR'S MANUAL

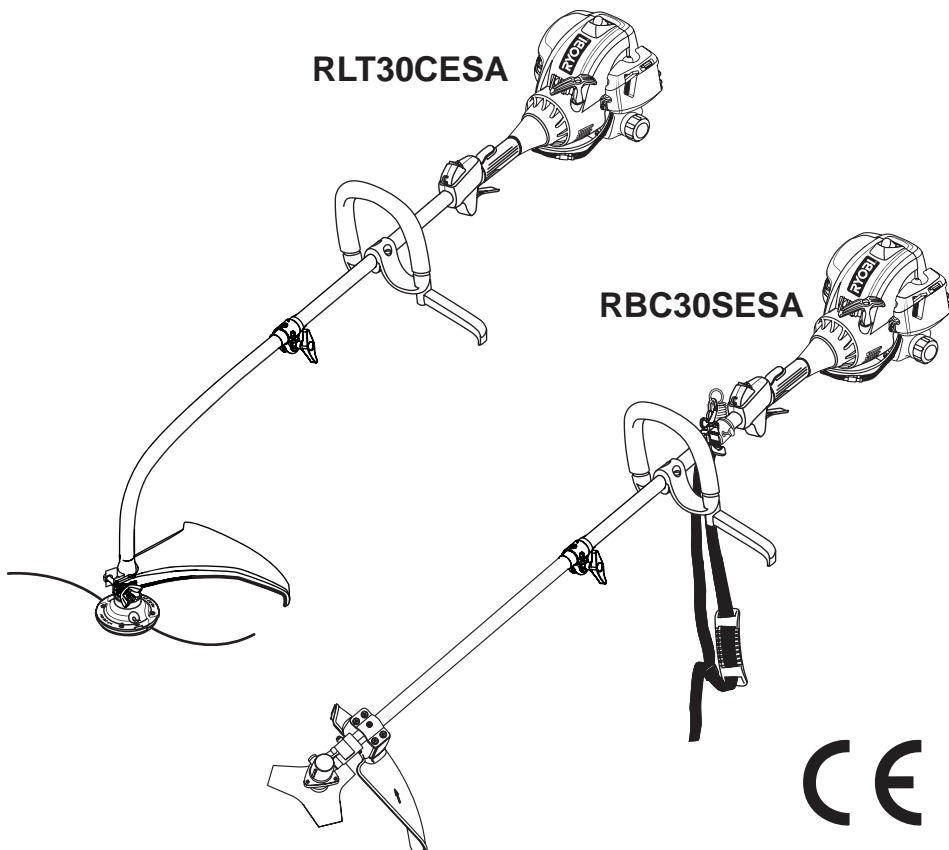

Important!

















It is essential that you read the instructions in this manual before mounting and operating this machine.

Subject to technical modifications.

CE



SYMBOLS

Important: Some of the following symbols may be used on your tool. Please study them and learn their meaning. Proper interpretation of these symbols will allow you to operate the tool better and more safely.

SYMBOLS	NAME	EXPLANATION
	Safety Alert Symbol	Indicates danger, warning or caution. it means attention!!! Your safety is involved.
	Read Your Operator's Manual	Your manual contains special messages to bring attention to potential safety concerns as well as operating and servicing information. Please read all the information carefully to ensure satisfaction and safe use.
	Wear eye, hearing and head protection	Wear eye, hearing and head protection when operating this equipment.
	Keep bystanders away	Keep all bystanders at least 15m (50 ft) away.
	Ricochet	Danger of Ricochet.
	Tri-Arc blade	Tri-Arc blade is appropriate for this unit and is suited for cutting pulpy weeds and vines.
	Do not use toothed blade	This unit is not intended for use with a toothed saw type blade.
	RPM Decal	Rotational direction and maximum speed of the shaft for the cutting attachment.
	Boots	Wear non-slip safety footwear when using this equipment.
	Gloves	Wear non-slip, heavy-duty gloves.
	No Smoking	Do not smoke when mixing fuel or filling fuel tank.
	Petrol	Use unleaded petrol intended for motor vehicle use with an octane rating of 87((R+M)/2) or higher.
	Lubricant	Use 2-stroke lubricant for air cooled engines.
	Mix Petrol and Lubricant	Mix the fuel mix thoroughly and also each time before refuelling.
	Switch	On/Off Switch I = ON to Run O = OFF to Stop
		Conforms to all regulatory standards in the country in the EU where the product is purchased.

SYMBOLS

The following signal words and meanings are intended to explain the levels of risk associated with this product.

SYMBOLS	NAME	EXPLANATION
	DANGER	Indicates an imminently hazardous situation, which, if not avoided, will result in death or serious injury.
	WARNING	Indicates a potentially hazardous situation, which, if not avoided, could result in death or serious injury.
	CAUTION	Indicates a potentially hazardous situation, which, if not avoided, may result in minor or moderate injury.
	CAUTION	(Without Safety Alert Symbol) Indicates a situation that may result in property damage.

SERVICE

Servicing requires extreme care and knowledge and should be performed only by a qualified service technician. For service we suggest you return the product to your nearest **AUTHORISED SERVICE CENTER** for repair. When servicing, use only identical replacement parts.



WARNING

To avoid serious personal injury, do not attempt to use this product until you read thoroughly and understand completely the operator's manual. Save this operator's manual and review frequently for continuing safe operation and instructing others who may use this product.

SAVE THESE INSTRUCTIONS

GENERAL SAFETY RULES

- For safe operation, read and understand all instructions before using the trimmer/brushcutter. Follow all safety instructions. Failure to follow all safety instructions listed below, can result in serious personal injury.
 - Do not allow children or untrained individuals to use this unit.
 - Never start or run the engine in a closed or poorly ventilated area; breathing exhaust fumes can kill.
 - Clear the work area before each use. Remove all objects such as rocks, broken glass, nails, wire, or string which can be thrown or become entangled in the string head or blade.
 - Wear full eye and hearing protection while operating this unit.
 - Wear heavy long trousers, boots, and gloves. Do not wear loose fitting clothing, shorts, jewellery of any kind, or use with bare feet.
 - Secure long hair so it is above shoulder level to prevent entanglement in any moving parts.
 - Keep all bystanders, children, and pets at least 15 m away.
 - Do not operate this unit when you are tired, ill, or under the influence of alcohol, drugs, or medication.
 - Do not operate in poor lighting.
 - Keep firm footing and balance. Do not overreach. Overreaching can result in loss of balance or exposure to hot surfaces.
 - Keep all parts of your body away from any moving part.
 - Do not touch area around the muffler or cylinder of the trimmer/brushcutter, these parts get hot from operation.
 - Always stop the engine and remove the spark plug wire before making any adjustments or repairs except for carburetor adjustments.
 - Inspect the unit before each use for loose fasteners, fuel leaks, etc. Replace any damaged parts before use.
 - The string head or blade will rotate during carburetor adjustments.
 - It has been reported that vibrations from hand-held tools may contribute to a condition called Raynaud's Syndrome in certain individuals. Symptoms may include tingling, numbness and blanching of the fingers, usually apparent upon exposure to cold. Hereditary factors, exposure to cold and dampness, diet, smoking and work practices are all thought to contribute to the development of these symptoms. There are measures that can be taken by the operator to possibly reduce the effects of vibration:
 - a) Keep your body warm in cold weather. When operating the unit wear gloves to keep the hands and wrists warm. It is reported that cold weather is a major factor contributing to Raynaud's Syndrome.
 - b) After each period of operation, exercise to increase blood circulation.
 - c) Take frequent work breaks. Limit the amount of exposure per day.
- If you experience any of the symptoms of this condition, immediately discontinue use and see your physician about these symptoms.
- Keep the tool well maintained, fasteners tightened and worn parts replaced.
 - Mix and store fuel in a container approved for fuel.
 - Mix fuel outdoors where there are no sparks or flames. Wipe up any fuel spillage. Move 9m away from refuelling site before starting engine.
 - Stop the engine and allow to cool before refueling or storing the unit.
 - Allow the engine to cool; empty the fuel tank and secure the unit from moving before transporting in a vehicle.

SPECIFIC SAFETY RULES

SPECIFIC SAFETY RULES FOR TRIMMER USE

- Replace string head if cracked, chipped, or damaged in any way. Be sure the string head or blade is properly installed and securely fastened. Failure to do so can cause serious injury.
- Make sure all guards, straps, deflectors and handles are properly and securely attached.
- Use only the manufacturer's replacement line in the cutting head. Do not use any other cutting attachment.
- Never operate unit without the grass deflector in place and in good condition.
- Maintain a firm grip on both handles while trimming. Keep string head below waist level. Never cut with the string head located over 76cm or more above the ground.

SPECIFIC SAFETY RULES FOR BRUSH CUTTER AND BLADE USE

- After engine stops, keep rotating blade in heavy grass or pulpy weeds until it stops.
- Do not operate the brushcutter unless the blade guard is firmly secured in place and in good condition.
- Use heavy gloves while installing or removing blades.
- Always stop the engine and remove the spark plug wire before attempting to remove any obstruction caught or jammed in the blade or before removing and installing the blade.
- Do not attempt to touch or stop the blade when it is rotating.
- A coasting blade can cause injury while it continues to spin after the engine is stopped or throttle trigger released. Maintain proper control until the blade has completely stopped rotating.
- Replace any blade that has been damaged. Always make sure blade is installed correctly and securely fastened before each use. Failure to do so can cause serious injury.
- Use only the manufacturer's replacement TRI-ARC blade intended for use on this brushcutter. Do not use any other blade.
- The TRI-ARC blade is suited for cutting pulpy weeds and vines only. Do not use for any other purpose. Never use the TRI-ARC blade to cut woody brush.
- Exercise extreme caution when using the blade with this unit. Blade thrust is the reaction that may occur when the spinning blade contacts anything it cannot cut. This contact may cause the blade to stop for an instant, and suddenly "thrust" the unit away from the object that was hit. This reaction can be violent

enough to cause the operator to lose control of the unit. Kick back can occur without warning if the blade snags, stalls, or binds. This is more likely to occur in areas where it is difficult to see the material being cut. For cutting ease and safety, approach the weeds being cut from the right to the left. In the event an unexpected object or woody stock is encountered, this could minimize the blade kick back reaction.

- Never cut any material over 13mm diameter.
- Always wear the shoulder strap when using the brush cutter and adjust to a comfortable operating position. Maintain a firm grip on both handles while cutting with a blade. Keep the blade away from body and below waist. Never use the brush cutter with the blade located 76cm or more above the ground level.
- Cover the blade with the blade protector before storing the unit, or during transportation. Always remove the blade protector before using the unit. If not removed, the blade protector could become a thrown object as the blade begins to turn.

SPECIFICATION

	RLT30CESA	RBC30SESA
Weight (kg)		
- Without fuel, cutting attachment and guard	5.02	5.67
- Without fuel with string head	5.32	5.97
- Without fuel with blade	N/A	5.97
Fuel tank volume [cm ³ or (L)]	415 or (0.415)	415 or (0.415)
Cutting swath (mm)		
- String head	432	457
- Blade	N/A	200
Recommended torque for blade (Nm)	N/A	≥13
Engine displacement (cm ³ / cc)	30	30
Line diameter for Reel Easy™ Head (mm)	2.4	2.4
Line diameter for Pro Cut II™ Head (mm)	2.7	2.7
Maximum engine performance (in accordance with ISO 8893) (kW)	0.75	0.75
Maximum rotational frequency of the the spindle (min ⁻¹)	12,000	10,000
Engine speed (rotational frequency) at recommended max. spindle rotational frequency (min ⁻¹)	12,000	12,000
Engine speed (rotational frequency) at idle (min ⁻¹)	2,800-3,500	2,800-3,500
Fuel consumption (in accordance with ISO 8893) at max. engine performance kg/h or (L/h)	0.42 or (0.58)	0.42 or (0.58)
Specific fuel consumption (in accordance with ISO 8893) at max. engine performance g/kW.h or (L/kW.h)	560 or (0.77)	560 or (0.77)
Vibration level idling (Trimmer) (m/s ²)		
- Front handle / Left handle	3.9	3.6
- Rear handle / Right handle	6.1	2.7
Vibration level racing (Trimmer) (m/s ²)		
- Front handle / Left handle	10.7	22.6
- Rear handle / Right handle	11.5	19.6
Vibration level idling (Brush Cutter) (m/s ²)		
- Front handle / Left handle	N/A	3.7
- Rear handle / Right handle	N/A	2.7
Vibration level racing (Brush Cutter) (m/s ²)		
- Front handle / Left handle	N/A	21.1
- Rear handle / Right handle	N/A	16.3
Sound pressure level at operator's ear (in accordance with EN 27917) dB (A)	100.4	105.1
Sound power level (in accordance with ISO 10884) dB (A)	112	113

FEATURES

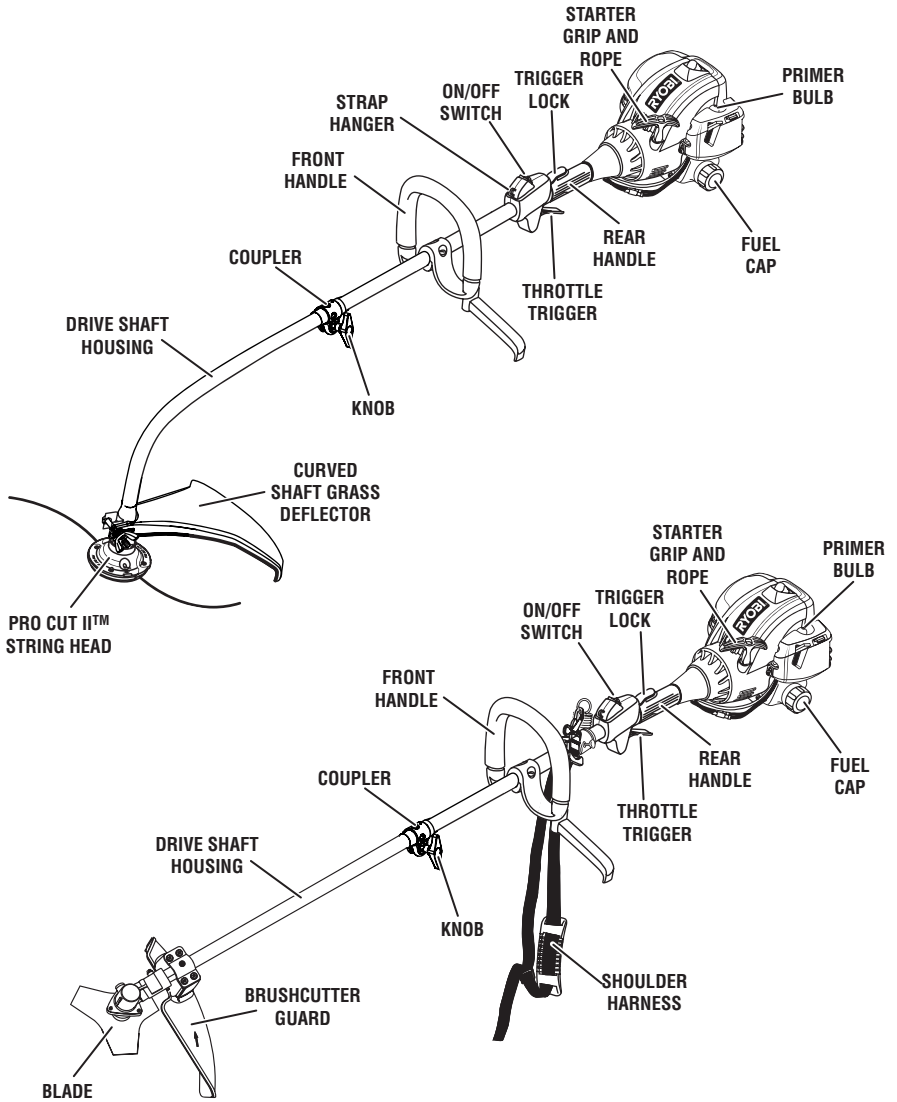
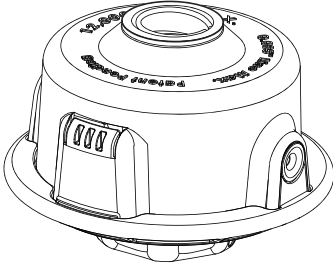

Fig. 1a

FEATURES

REEL EASY STRING HEAD



PRO CUT II STRING HEAD

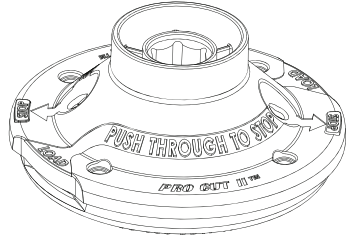

Fig. 1b

KNOW YOUR LINE TRIMMER

See Figures 1a - 1b.

The safe use of this product requires an understanding of the information on the tool and in this operator's manual as well as a knowledge of the project you are attempting. Before use of this product, familiarise yourself with all operating features and safety rules.

ERGONOMIC DESIGN

The design of the trimmer provides for easy handling. It is designed for comfort and ease of grasp when operating in different positions and at different angles.

GRASS DEFLECTOR

The trimmer includes a grass deflector that helps protect you from flying debris.

TOP-MOUNTED MOTOR

The top-mounted motor improves balance and is located away from the dust and debris of the cutting area.

ASSEMBLY

UNPACKING

This product requires assembly.

- Carefully remove the tool and any accessories from the box. Make sure that all items listed in the packing list are included.
- Inspect the tool carefully to make sure no breakage or damage occurred during shipping.
- Do not discard the packing material until you have carefully inspected and satisfactorily operated the tool.
- If any parts are damaged or missing, please call 0800 389 0305 for assistance.

PACKING LIST

RLT30CESA

Trimmer Assembly
Pro Cut II String Head
Spool Retainer
Front Handle
Curved Shaft Grass Deflector
Bottle of 2-Cycle Lubricant
Hanger Cap
Operator's Manual

RBC30SESA

Brush Cutter Assembly
Front Handle
Grass Deflector
Blade Guard
Harness
Gear Head Locking Tool
Pro Cut II String Head
Spool Retainer
Arbor
Bottle of 2-Cycle Lubricant
Tri-Arc Blade
Hanger Cap
Operator's Manual



WARNING

If any parts are damaged or missing do not operate this product until the parts are replaced. Failure to heed this warning could result in serious personal injury.



WARNING

Do not attempt to modify this product or create accessories not recommended for use with this product. Any such alteration or modification is misuse and could result in a hazardous condition leading to possible serious personal injury.



WARNING

To prevent accidental starting that could cause serious personal injury, always disconnect the engine spark plug wire from the spark plug when assembling parts.

ASSEMBLY

INSTALLING THE POWER HEAD TO THE ATTACHMENT

See Figure 2.



WARNING

Never install, remove, or adjust any attachment while power head is running. Failure to stop the engine can cause serious personal injury.

The attachment connects to the power head by means of a coupler device.

- Loosen the knob on the coupler of the power head shaft and remove the end cap from the attachment.
- Push in the button located on the attachment shaft. Align the button with the guide recess on the power head coupler and slide the two shafts together. Rotate the attachment shaft until the button locks into the positioning hole.

NOTE: If the button does not release completely in the positioning hole, the shafts are not locked into place. Slightly rotate from side to side until the button is locked into place.

- Tighten the knob securely.



WARNING

Be certain the knob is fully tightened before operating equipment; check it periodically for tightness during use to avoid serious personal injury.

REMOVING THE ATTACHMENT FROM THE POWER HEAD

For removing or changing the attachment:

- Loosen the knob.
- Push in the button and twist the shafts to remove and separate ends.

ATTACHING THE STORAGE HANGER

See Figure 3.

There are two ways to hang your attachment for storage.

- To use the hanger cap, push in the button and place the hanger cap over end of the lower end attachment shaft. Slightly rotate the cap from side to side until the button locks into place.
- The secondary hole in the attachment shaft can be used for hanging purposes as well.

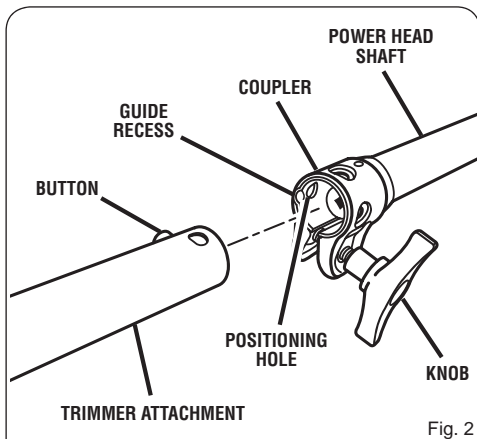

Fig. 2

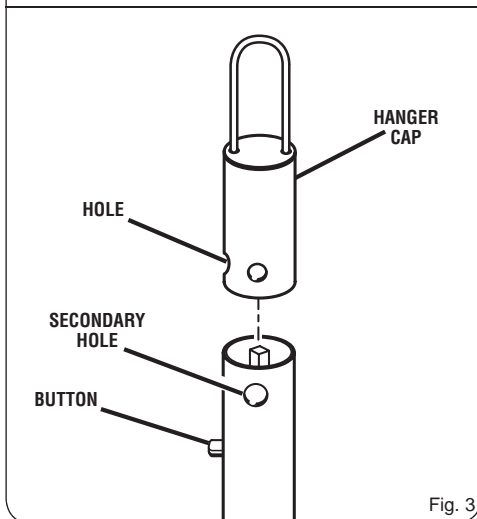

Fig. 3

ASSEMBLY

ATTACHING THE FRONT HANDLE

See Figure 4.

Follow these steps to attach the front handle.

- Remove the slotted Torx screws to separate the handle from the handle support.
- Press the handle onto the top of the upper shaft, no less than 165mm from the edge of the trigger handle, angling the handle toward the trigger handle.
- Place the handle along the upper shaft to a position that allows for comfortable operation.
- Place the handle support on the bottom of the tube on the opposite side of the front handle.
- Secure the handle with the slotted Torx screws.

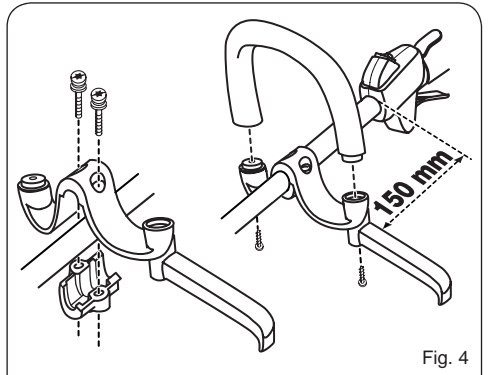

Fig. 4

ATTACHING THE GRASS DEFLECTOR



WARNING

The line cutting blade on the grass deflector is sharp. Avoid contact with the blade. Failure to avoid contact can result in serious personal injury.

TO ATTACH THE CURVED SHAFT GRASS DEFLECTOR

See Figure 5. (RLT30CESA)

- Remove hex screw, flat washer, and wing nut from grass deflector.
- Press the grass deflector onto the bottom of the curved shaft as shown.
- Insert the hex screw through the grass deflector and the bracket on the curved shaft.
- Place the flat washer on the hex screw.
- Place the wing nut on the hex screw and tighten securely.

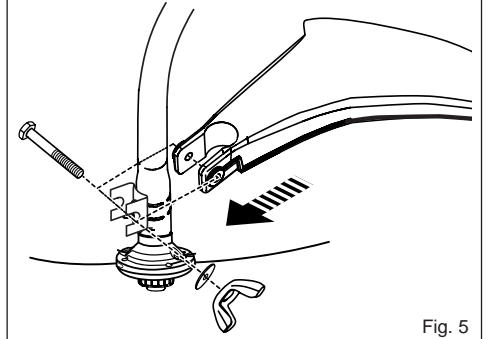

Fig. 5

TO ATTACH THE BRUSH CUTTER GUARD

See Figure 6. (RBC30SESA)

- Attach the blade guard to the mounting bracket; install the four screws from the top of the mounting bracket through the blade guard and into the threaded mounting plates.
- Using the torx wrench supplied, tighten all four screws securely.

NOTE: When using the string head, the grass deflector must be attached to the blade guard.

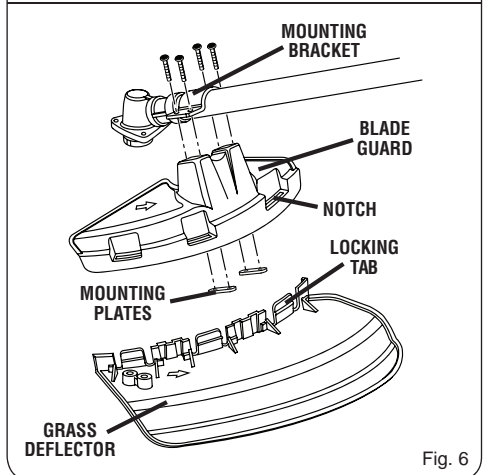

Fig. 6

ASSEMBLY

TO ATTACH THE GRASS DEFLECTOR ON THE BRUSH CUTTER GUARD

See Figure 6. (RBC30SESA)

- Attach the grass deflector to the blade guard by placing the three locking tabs into the three notches.
- Snap the blade guard and grass deflector together to lock into place.



WARNING

Always stop the engine and remove the spark plug wire before making any adjustments such as changing cutting heads; this is to reduce the risk of serious personal injury.

ATTACHING THE SHOULDER HARNESS

See Figure 7. (RBC30SESA)

- Connect the latch on the shoulder harness to the strap hanger.
- Adjust the strap to a comfortable position.

CONVERTING FROM BRUSH CUTTER TO STRING TRIMMER (RBC30SESA)

- To convert from the brush cutter to the string trimmer, remove the blade, attach the grass deflector and install the string head.

REMOVING THE TRI -ARC® BLADE

See Figures 8 - 9. (RBC30SESA)

- Align the slot in the flanged washer with the slot in the gear head.
- Place the gear head locking tool through the slot in the flanged washer and gear head.
- Remove the blade nut by turning it clockwise.
- Remove the cupped washer and the blade.
- Remove the flanged washer from the gear head shaft and retain it for the string head installation.

NOTE: Store the brushcutter parts together for later use.

INSTALLING THE GRASS DEFLECTOR AND LINE HEAD

See Figures 10. (RBC30SESA)

- Install the grass deflector. Refer to "To attach the grass deflector on the brush cutter guard" earlier in this manual.
- Place the flanged washer on the gear head shaft.

NOTE: The hollow side of the flanged washer should face the gear head.

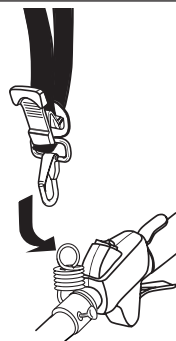

Fig. 7

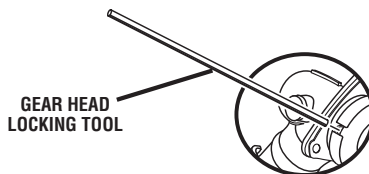

Fig. 8

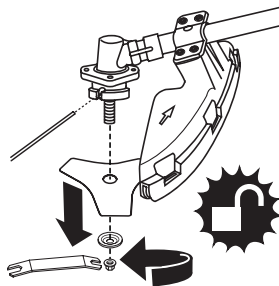

Fig. 9

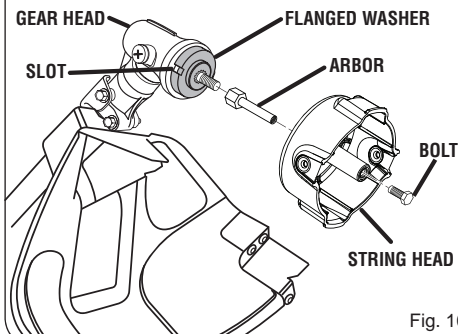

Fig. 10

ASSEMBLY

- Install the arbor.
- Install the string head assembly onto the gear head shaft.
- Refer to Installing Reel Easy String Head or Installing Pro Cut II String Head later in this manual.

CONVERTING FROM STRING TRIMMER TO BRUSH CUTTER (RBC30SESA)

- To convert from the string trimmer to the brush cutter, remove the string head assembly and grass deflector, install the blade.

REMOVING THE GRASS DEFLECTOR AND LINE HEAD

See Figures 11. (RBC30SESA)

- Remove the grass deflector by pushing in on the three locking tabs while pulling on the grass deflector to separate from the blade guard.
- Align the slot in the flanged washer with the slot in the gear head.
- Remove the hex head bolt and string head assembly.
- Remove the arbor.
- Remove the flanged washer and retain it for the blade installation.

NOTE: Store the string head parts together for later use.

INSTALLING THE TRI -ARC® BLADE

See Figures 12. (RBC30SESA)

- Place the flanged washer over the gear head shaft with the hollow side toward the gear head.
- Centre the blade on the flanged washer, making sure the blade fits flat and the raised hub of the flanged washer goes through the hole in the blade.
- Install the cupped washer with the raised centre away from the blade.
- Place the blade nut onto the gear head shaft.
- Place the gear head locking tool through the slot in the flanged washer and gear head.
- Install the blade nut by turning it counterclockwise (left handed threads).
- Tighten the blade nut securely and torque to 13.5Nm minimum.

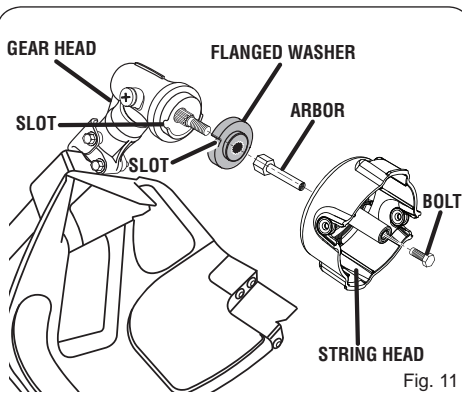

Fig. 11

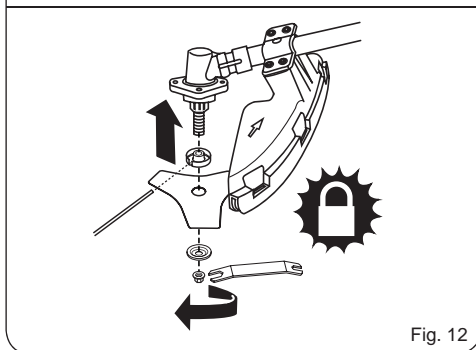

Fig. 12

OPERATION



WARNING

Do not allow familiarity with this product to make you careless. Remember that a careless fraction of a second is sufficient to inflict serious injury.



WARNING

Always wear safety goggles or safety glasses with side shields when operating power tools. Failure to do so could result in objects being thrown into your eyes resulting in possible serious injury.



WARNING

Do not use any attachments or accessories not recommended by the manufacturer of this product. The use of attachments or accessories not recommended can result in serious personal injury.

FUELING AND REFUELING THE TRIMMER

FUEL MIXTURE

This product is powered by a 2-cycle engine and requires pre-mixed petrol and 2-cycle lubricant. Pre-mix unleaded petrol and 2-cycle engine lubricant in a clean 5 litre container approved for petrol.

- Recommended fuel: This engine is certified to operate on unleaded petrol intended for automotive use.
- Mix a high quality 2-cycle engine lubricant at 20ml. per 1 litre.
- Do not use automotive lubricant or 2-cycle outboard lubricant.
- DO NOT mix quantities larger than usable in a 30 day period.

HIGH QUALITY 2-CYCLE ENGINE LUBRICANT



Petrol

1 litre

lubricant

20 ml

FILLING TANK

- Clean surface around fuel cap to prevent contamination.
- Loosen fuel cap slowly. Rest the cap on a clean surface.
- Carefully pour fuel into the tank. Avoid spillage.
- Prior to replacing the fuel cap, clean and inspect the gasket.
- Immediately replace fuel cap and hand tighten. Wipe up any fuel spillage.

NOTE: It is normal for smoke to be emitted from a new engine after first use.



WARNING

Always shut off engine before fuelling. Never add fuel to a machine with a running or hot engine. Move at least 10m from refuelling site before starting engine. Do not smoke! Failure to heed this warning could result in serious personal injury.

OPERATION

OPERATING THE TRIMMER

See Figure 13.



WARNING

Always position the unit on the operator's right side. The use of the unit on the operator's left side will expose the user to hot surfaces and can result in possible burn injury.



WARNING

To avoid burns from hot surfaces, never operate unit with the bottom of the engine above waist level.

Hold the trimmer with your right hand on the rear handle and your left hand on the front handle. Keep a firm grip with both hands while in operation. Trimmer should be held at a comfortable position with the rear handle about hip height.

Always operate trimmer at full throttle. Cut tall grass from the top down. This will prevent grass from wrapping around the shaft housing and string head which could cause damage from overheating. If grass becomes wrapped around the string head, STOP THE ENGINE, disconnect the spark plug wire, and remove the grass. Prolonged cutting at partial throttle will result in lubricant dripping from the muffler.



WARNING

Always hold the string trimmer away from the body keeping clearance between the body and the product. Any contact with the housing or string trimmer cutting head can result in burns and/or other serious personal injury.

TO ADVANCE THE CUTTING LINE (REEL EASY STRING HEAD)

String advance is controlled by tapping the string head on grass while running engine at full throttle.

- Run engine at full throttle.
- Tap the knob on ground to advance string. The string advances each time the knob is tapped. Do not hold the knob on the ground.

NOTE: The line trimming cut-off blade on the grass deflector will cut the line to the correct length.

NOTE: If the string is worn too short you may not be able to advance the string by tapping it on the ground. If so, stop the engine, and manually advance the string.

To advance the cutting line manually:

- Stop the engine and disconnect the spark plug wire.
- Push the knob in while pulling on string(s) to manually advance the string.

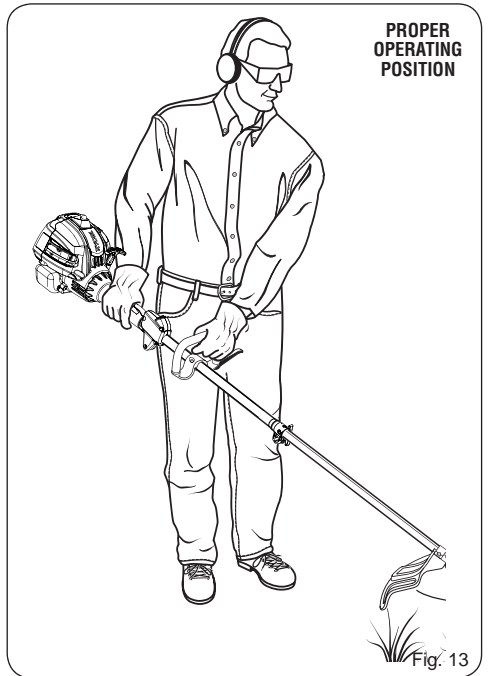

OPERATION

CUTTING TIPS

See Figures 14 .

- Avoid hot surfaces by always keeping the tool away from your body. (Proper operating position shown in figure 13.)
- Keep the trimmer tilted toward the area being cut; this is the best cutting area.
- The curved shaft trimmer cuts when passing the unit from right to left. The straight shaft trimmer cuts when passing the unit from left to right. This will avoid throwing debris at the operator. Avoid cutting in the dangerous area shown in illustration.
- Use the tip of string to do the cutting; do not force string head into uncut grass.
- Wire and picket fences cause extra string wear, even breakage. Stone and brick walls, curbs, and wood may wear string rapidly.
- Avoid trees and shrubs. Tree bark, wood moldings, siding, and fence posts can easily be damaged by the string.

GRASS DEFLECTOR LINE TRIMMING CUT-OFF BLADE

See Figure 15.

The trimmer is equipped with a line trimming cut-off blade on the grass deflector. For best cutting, advance string until it is trimmed to length by the cut-off blade. Advance the line whenever you hear the engine running faster than normal, or when trimming efficiency diminishes. This will maintain best performance and keep the string long enough to advance properly.

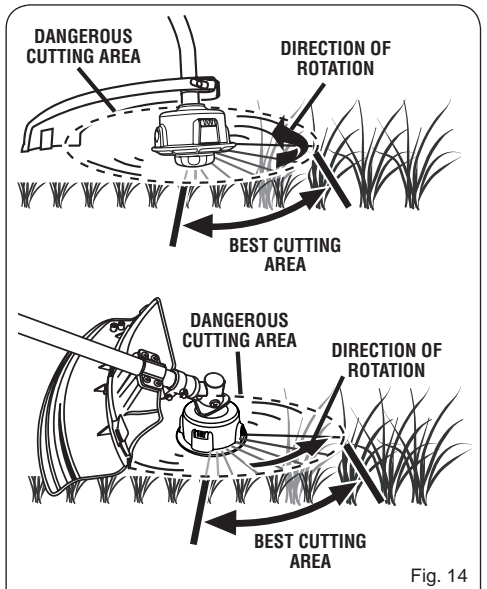

Fig. 14

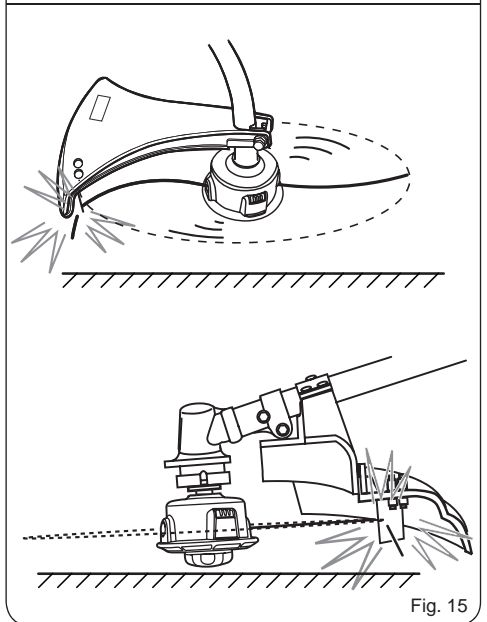

Fig. 15

OPERATION

OPERATING THE BRUSHCUTTER

See Figures 16 - 17.

Hold the brushcutter with your right hand on the rear handle and the your hand on the “J” handle. Keep a firm grip with both hands while in operation. Brushcutter should be held at a comfortable position with the rear handle about hip height. Maintain your grip and balance on both feet. Position yourself so that you will not be drawn off balance by the kickback reaction of the cutting blade.

Adjust the shoulder harness to position the brushcutter at a comfortable operating position and to assure that the shoulder harness will reduce the risk of operator contact with the blade.

BLADE THRUST

Exercise extreme caution when using the blade with this unit. Blade thrust is the reaction that may occur when the spinning blade contacts anything it cannot cut. This contact may cause the blade to stop for an instant, and suddenly “thrust” the unit away from the object that was hit. This reaction can be violent enough to cause the operator to lose control of the unit. Blade thrust can occur without warning if the blade snags, stalls, or binds. This is more likely to occur in areas where it is difficult to see the material being cut. For cutting ease and safety, approach the weeds being cut with the brushcutter from the right to the left. In the event an unexpected object or woody stock is encountered, this practice could minimize the blade thrust reaction.



WARNING

To avoid burns from hot surfaces, never operate unit with the bottom of the engine above waist level.

TRI-ARC® BLADE

The Tri-Arc® blade is suited only for thicker weeds and pulpy stalks. When the blade becomes dull, it can be turned over to extend the life of the blade. Do not sharpen the Tri-Arc® blade.

CUTTING TECHNIQUE - BLADE



WARNING

Extreme care must be taken when using blades to ensure safe operation. Read the safety information for safe operation using the blade, refer to Specific Safety Rules for Brushcutter and Blade Use earlier in this manual.

- Always hold brushcutter on your right side with both hands when operating. Use a firm grip on both handles.
- Maintain your grip and balance on both feet. Position yourself so that you will not be drawn off balance by the kickback reaction of the cutting blade.

- Inspect and clear the area of any hidden objects such as glass, rocks, concrete, fencing, wire, wood, metal, etc.
- Never use blades near sidewalks, fencing, posts, buildings or other immovable objects.
- Never use a blade after hitting a hard object without first inspecting it for damage. Do not use if any damage is detected.
- The unit is used as a scythe, cutting from the right to the left in a broad sweeping action from side to side.
- Use only the Tri-Arc® blade. To install any other brand blade or cutting head to this brushcutter can result in serious personal injury.

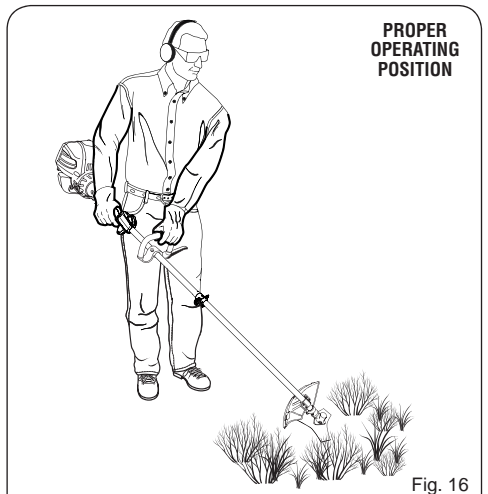

Fig. 16

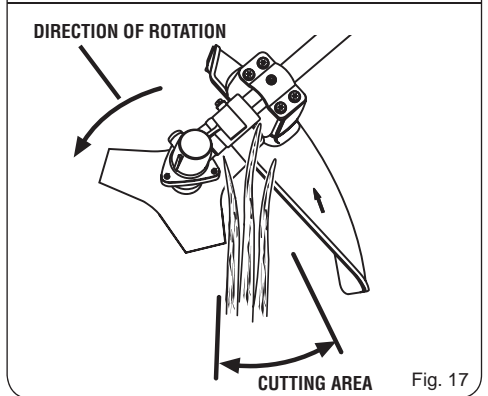

Fig. 17

OPERATION

STARTING AND STOPPING

See Figures 18 - 20.

To start a cold engine:

DO NOT squeeze the throttle trigger until the engine starts and runs.

- Lay the trimmer on a flat, bare surface.
- **PRIME** - Press the primer bulb 7 times.
- **SET** the start lever to the **START** position.
- **PULL** the rope until the engine starts.
- Wait 6-10 seconds, then squeeze the trigger to run.

NOTE: Squeezing and releasing the throttle trigger releases the start lever to the **RUN** position.

To start a warm engine:

PULL the rope until the engine starts.

To stop the engine:

Press and hold the switch in the stop "O" position until the engine stops.

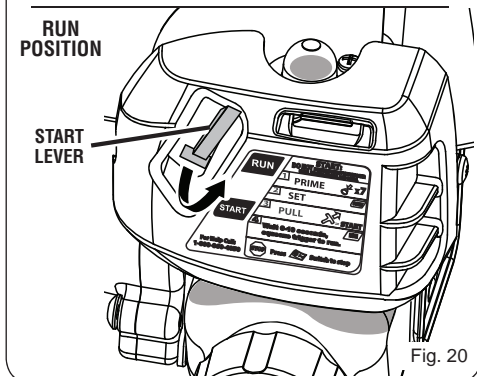
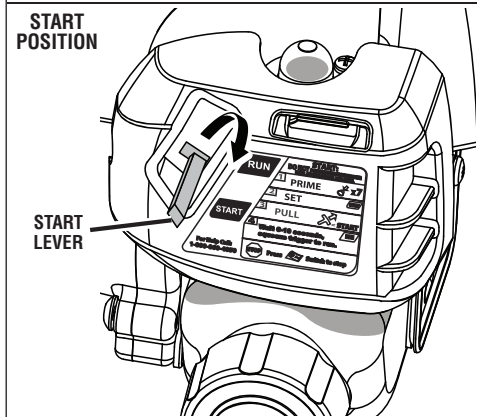
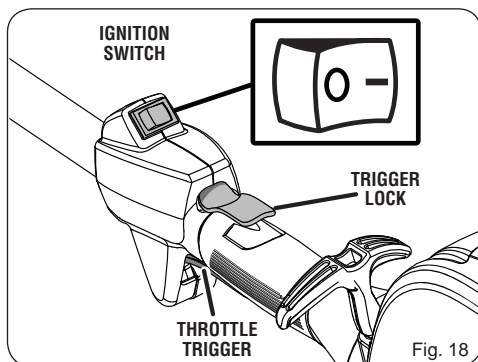
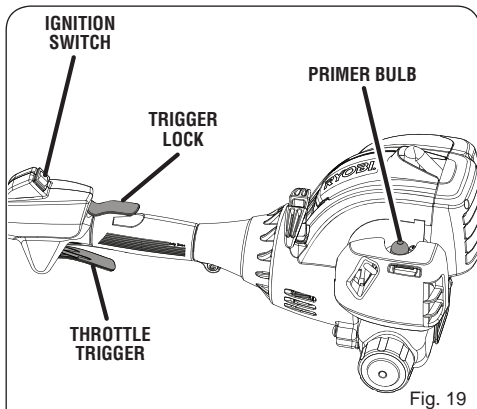

MAINTENANCE



WARNING

When servicing, use only identical replacement parts. Use of any other parts may create a hazard or cause product damage.



WARNING

Always wear safety goggles or safety glasses with side shields during tool operation. If operation is dusty, also wear a dust mask.



WARNING

Before inspecting, cleaning, or servicing the machine, shut off engine, wait for all moving parts to stop, and disconnect spark plug wire and move it away from spark plug. Failure to follow these instructions can result in serious personal injury or property damage.

GENERAL MAINTENANCE

Avoid using solvents when cleaning plastic parts. Most plastics are susceptible to damage from various types of commercial solvents and may be damaged by their use. Use clean cloths to remove dirt, dust, lubricant, grease, etc.



WARNING

Do not at any time let brake fluids, petrol, petroleum-based products, penetrating lubricants, etc., come in contact with plastic parts. Chemicals can damage, weaken or destroy plastic which may result in serious personal injury.

You can often make adjustments and repairs described here. For other repairs, have the trimmer serviced by an authorised service dealer.

INSTALLING REEL EASY STRING HEAD

See Figures 21 - 22.

- Stop the engine and disconnect the spark plug wire.
- Remove currently installed string head.
- Open the Reel Easy String Head by depressing the latches on each side. The contents of the string head are spring loaded, so keep your other hand over the string head cover while depressing the latches.
- Remove the string head cover, knob, and spool and set aside.
- Place the string head on the drive shaft. Make sure the string head is fully seated.
- Install the hex bolt into the opening on the drive shaft and secure using the hex-shaped opening in the knob to tighten.

NOTE: Only use the knob to tighten the bolt. The use of other tools may allow overtightening of the bolt, which

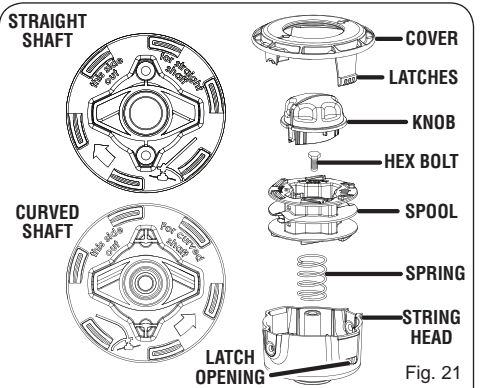

Fig. 21

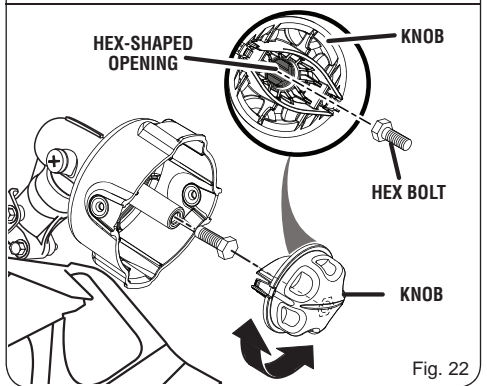

Fig. 22

could damage the string head.

NOTE: For the RBC30SESA, the gear head locking tool can be inserted through the slot in the flanged washer and gear head to help hold the string head still.

- If removed, replace the spring into the string head and push down to seat.
- Reinstall the spool. For the RLT30CESA, the spool should be placed so "This side out for curved shaft" is visible. For the RBC30SESA, the spool should be placed so "This side out for straight shaft" is visible.
- Replace the knob in the spool.
- Replace the string head cover, aligning latches with openings in the string head. Press cover and string head together until both latches snap into openings securely.
- Install string as described in the next section of this manual.

MAINTENANCE

INSTALLING STRING IN REEL EASY LINE HEAD

See Figures 23 - 24.

Use 2.4mm diameter monofilament string.

- Stop the engine and disconnect the spark plug wire.
- Cut one piece of string approximately 7.6m in length.
- Rotate knob on string head until line on knob aligns with arrows on top of string head.
- Insert one end of string into eyelet located on the side of the string head and push until string comes out through eyelet on the other side. Continue to push string through the string head until the middle section of the string is inside the string head and string outside the string head is evenly divided on each side.
- Rotate the knob on the string head (clockwise for RBC30SESA and counterclockwise for RLT30CESA) to wind the string.
- Wind the string until approximately 20cm remains protruding from the string head.

INSTALLING PRO CUT II STRING HEAD

See Figure 25.

- Stop the engine and disconnect the spark plug wire.
- Remove currently installed string head.
- Install the string head on the drive shaft until fully seated.
- Install string.

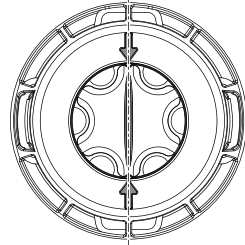

ALIGN
LINE ON
KNOB WITH
ARROWS

Fig. 23

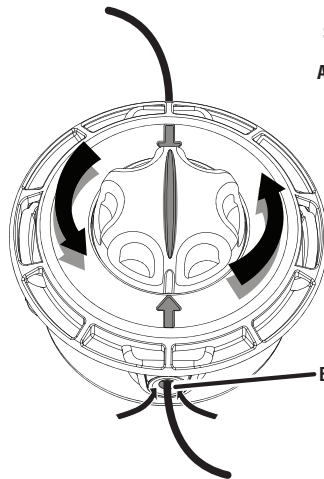

INSERT
STRING TO
CENTER
AND ROTATE
KNOB TO
WIND

Fig. 24

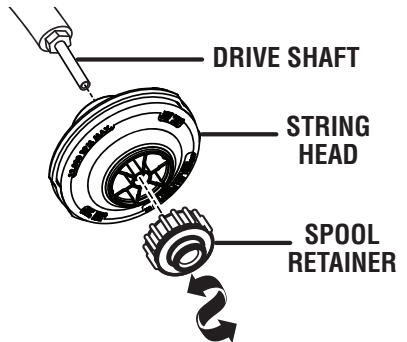

Fig. 25

MAINTENANCE

INSTALLING STRING IN PRO CUT II STRING HEAD

See Figure 26.

Use monofilament string between 2.4mm and 2.7mm diameter. Use original manufacturer's replacement string for best performance.

- Stop the engine and disconnect the spark plug wire.
- Gather two of the pre-cut lengths of trimmer line provided or cut two pieces of trimmer line, in 28cm lengths.
- Insert the strings into the slots located on the sides of the string head. String should be pushed in until approximately 25mm protrudes from the holes on the top of the string head.
- Remove old string by pulling it from the holes located on the top of the string head.

CLEANING THE EXHAUST PORT AND MUFFLER

NOTE: Depending on the type of fuel used, the type and amount of lubricant used, and/or your operating conditions, the exhaust port, muffler, and/or spark arrestor screen may become blocked with carbon deposits. If you notice a power loss with your gas powered tool, you may need to remove these deposits to restore performance. We highly recommend that only qualified service technicians perform this service.

SPARK ARRESTOR

The spark arrestor must be cleaned or replaced every 50 hours or yearly to ensure proper performance of your product. Spark arrestors may be in different locations depending on the model purchased. Please contact your nearest service dealer for the location of the spark arrestor for your model.

IDLE SPEED ADJUSTMENT

See Figure 27.

If the cutting attachment turns at idle, the idle speed screw needs adjusting on the engine. Turn the idle speed screw counterclockwise to reduce the idle RPM and stop the cutting attachment movement. If the cutting attachment still moves at idle speed, contact a service dealer for adjustment and discontinue use until the repair is made.



WARNING

The cutting attachment should never turn at idle. Turn the idle speed screw counterclockwise to reduce the idle RPM and stop the cutting attachment, or contact a service dealer for adjustment and discontinue use until the repair is made. Serious personal injury may result from the cutting attachment turning at idle.

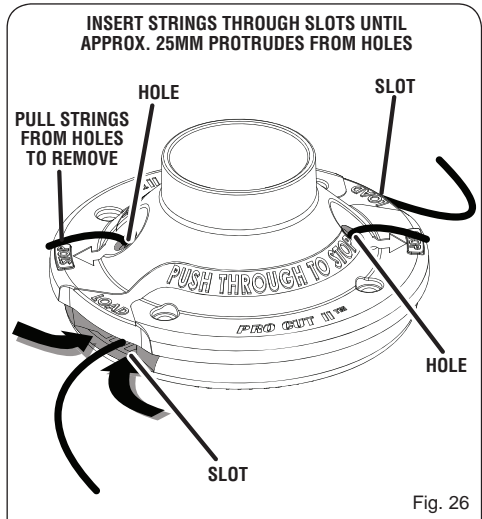

Fig. 26

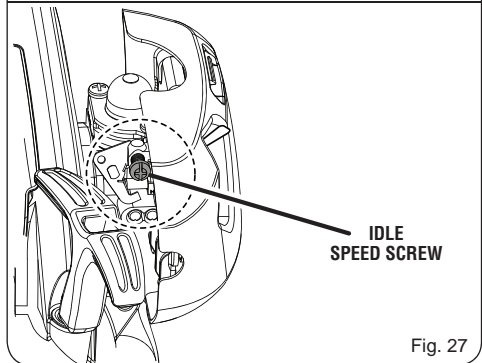

Fig. 27

MAINTENANCE

CLEANING AIR FILTER SCREEN

See Figures 28 - 29.

For proper performance and long life, keep air filter screen clean.

- Remove the air filter cover by pushing down on the latch with your thumb while gently pulling on the cover.
- Brush the air filter screen lightly to clean.
- Replace the air filter cover by inserting the tabs on the bottom of the cover into the slots on the air filter base; push the cover up until it latches securely in place.

FUEL CAP



WARNING

A leaking fuel cap is a fire hazard and must be replaced immediately.

The fuel cap contains a non-serviceable filter and a check valve. A clogged fuel filter will cause poor engine performance. If performance improves when the fuel cap is loosened, check valve may be faulty or filter clogged. Replace fuel cap if required.

SPARK PLUG REPLACEMENT

This engine uses a Champion RCJ-6Y or NGK BPMR7A spark plug with .025 in. electrode gap. Use an exact replacement and replace annually.

STORING THE PRODUCT

- Clean all foreign material from the product. Store idle unit indoors in a dry, well-ventilated area that is inaccessible to children. Keep away from corrosive agents such as garden chemicals and de-icing salts.
- Abide by all ISO and local regulations for the safe storage and handling of gasoline.

When storing 1 month or longer:

- Drain all fuel from tank into a container approved for gasoline. Run engine until it stops.

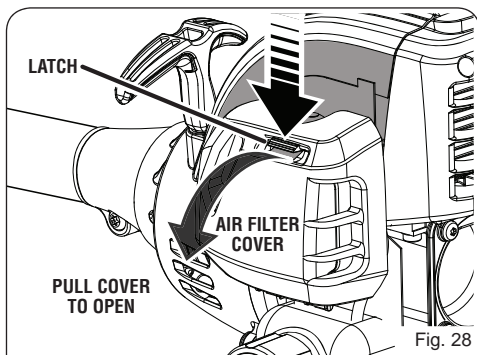

Fig. 28

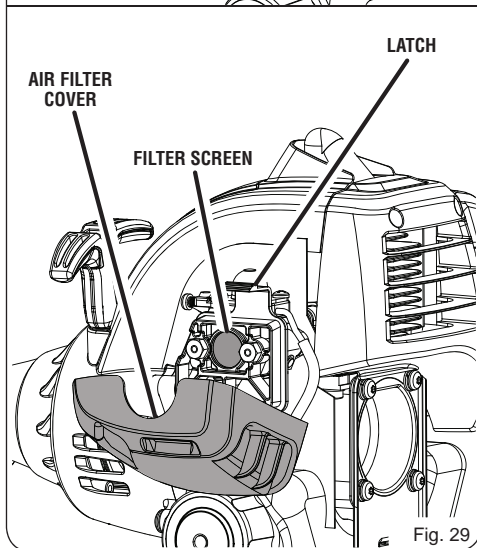

Fig. 29

TROUBLESHOOTING

IF THESE SOLUTIONS DO NOT SOLVE THE PROBLEM CONTACT YOUR AUTHORISED SERVICE DEALER.

PROBLEM	POSSIBLE CAUSE	SOLUTION
Engine will not start	<ol style="list-style-type: none"> 1. No spark. 2. No fuel. 3. Engine is flooded. 	<ol style="list-style-type: none"> 1. Clean or replace spark plug. Reset spark plug gap. Refer to Spark Plug Replacement earlier in this manual. 2. Push primer bulb until bulb is full of fuel. If bulb does not fill, primary fuel delivery system is blocked. Contact a service dealer. If primer bulb fills, engine may be flooded, proceed to next item. 3. Set the start lever to the START position. Squeeze the trigger and pull the rope repeatedly until the engine starts and runs. NOTE: Depending on the severity of the flooding, this may require numerous pulls of the rope.
Engine does not reach full speed and emits excessive smoke	<ol style="list-style-type: none"> 1. Incorrect lubricant/fuel mixture. 2. Air filter screen is dirty. 3. Spark arrestor screen is dirty. 4. Spark plug fouled. 	<ol style="list-style-type: none"> 1. Use fresh fuel and the correct 2-cycle lubricant mix. (50:1). 2. Clean air filter screen. Refer to Cleaning Air Filter Screen earlier in this manual. 3. Contact a servicing dealer. 4. Clean or replace spark plug. Reset spark plug gap. Refer to Spark Plug Replacement earlier in this manual.
Engine starts, runs, and accelerates but will not idle	<ol style="list-style-type: none"> 1. Idle speed screw on carburetor needs adjustment. 	<ol style="list-style-type: none"> 1. Turn idle speed screw clockwise to increase idle speed. <i>See Figure 30.</i>
String will not advance	<ol style="list-style-type: none"> 1. String is welded to itself. 2. Not enough string on spool. 3. String is worn too short. 4. String is tangled on spool. 5. Engine speed is too slow. 	<ol style="list-style-type: none"> 1. Lubricate string with silicone spray. 2. Install more string. Refer to the applicable string replacement section in this manual. 3. Pull strings while alternately pressing down on and releasing spool retainer. 4. Remove string from spool and rewind. Refer to the applicable string replacement section in this manual. 5. Advance string at full throttle.

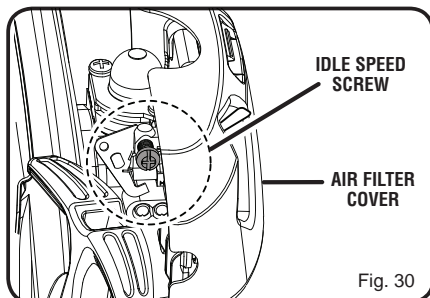

Fig. 30

TROUBLESHOOTING

IF THESE SOLUTIONS DO NOT SOLVE THE PROBLEM CONTACT YOUR AUTHORISED SERVICE DEALER.

PROBLEM	POSSIBLE CAUSE	SOLUTION
Spool retainer hard to turn	1. Screw threads are dirty or damaged.	1. Clean threads and lubricate with grease - if no improvement, replace the spool retainer.
Grass wraps around driveshaft housing and string head	1. Cutting tall grass at ground level. 2. Operating trimmer at part throttle.	1. Cut tall grass from the top down to prevent wrapping. 2. Operate trimmer at full throttle.

WARRANTY

THIS PRODUCT WAS MANUFACTURED WITH A CATALYST MUFFLER

Congratulations! You have made an investment toward protecting the environment. In order to maintain this product's original emission level, please refer to the maintenance section below.

EMISSIONS MAINTENANCE SCHEDULE AND WARRANTED PARTS LIST

Emissions Parts	Inspect Before Each Use	Clean Every 5 Hours	Replace Every 25 Hours or Yearly	Clean Every 25 Hours or Yearly	Replace Every 50 Hours
-----------------	----------------------------	------------------------	--	--------------------------------------	---------------------------

CATALYTIC MUFFLER ASSEMBLY X

AIR FILTER ASSY

includes:

Filter Screen X

SPARK SCREEN X

CARBURETOR ASSY

includes:

Heat Dam X

Gaskets X

FUEL TANK ASSY

includes:

Fuel Lines X

Fuel Cap X

Fuel Filter

IGNITION ASSY

includes:

Spark Plug X

ALL EMISSIONS-RELATED PARTS ARE WARRANTED FOR TWO YEARS OR FOR THE PERIOD OF TIME PRIOR TO THE PARTS FIRST SCHEDULED REPLACEMENT WHICHEVER COMES FIRST.

LIMITED WARRANTY

TTI warrants this outdoor product to be free of defects in material or workmanship for 24 months from the date of purchase by the original purchaser, subject to the limitations below. Please keep your invoice as proof of date of purchase.

This warranty is only applicable where the product is used for personal and non-commercial purposes. This warranty does not cover damage or liability caused by / due to misuse, abuse, accidental or intentional acts by user, improper handling, unreasonable use, negligence, failure by end user to follow operating procedures outlined in the user's manual, attempted repair by non-qualified professional, unauthorized repair, modification, or use of accessories and/or attachments not specifically recommended by authorized party.

This warranty does not cover belts, brushes, bags, bulbs or any part which ordinary wear and tear results in required replacement during warranty period. Unless specifically provided under applicable law, this warranty does not cover transportation cost or consumable items such as fuses.

This limited warranty is void if the product's original identification (trade mark, serial number, etc.) markings have been defaced, altered or removed or if product is not purchased from an authorized reseller or if product is sold AS IS and / or WITH ALL FAULTS.

Subject to all applicable local regulations, the provisions of this limited warranty are in lieu of any other written warranty, whether express or implied, written or oral, including any warranty of MERCHANTABILITY OR FITNESS FOR A PARTICULAR PURPOSE. IN NO EVENT SHALL WE BE LIABLE FOR SPECIAL, INCIDENTAL, CONSEQUENTIAL OR INCIDENTAL DAMAGES. OUR MAXIMUM LIABILITY SHALL NOT EXCEED THE ACTUAL PURCHASE PRICE PAID BY YOU FOR THE PRODUCT.

This warranty is valid only in the European Union, Australia and New Zealand. Outside these areas, please contact your authorized Ryobi dealer to determine if another warranty applies.

CE DECLARATION OF CONFORMITY

We declare in sole responsibility that the product, to which this manual applies, conforms to the basic health and safety requirements of the Machinery Directive 98/37/EC, 2006/42/EC and other relevant directives, like EMC Directive 2004/108/EC and Directive 2000/14/EC, Gas Emission Directive 97/68/EC ammended by 2004/26/EC.

To effect correct application of the health and safety requirements stated in the EEC directives, the following European and/or national standards and/or technical specifications were consulted:

EN ISO 14982:1998, EN ISO 11806:1997, ISO 7918-1995, ISO 8380-1993, ISO 8893-1989, EN ISO 12100-1:2003, EN ISO 12100-2:2003, EN 563-1994, ISO 7112-1982, ISO 7113-1991, EN ISO 22867-2006, EN ISO 22868-2006.

We declare this product complies to the requirements of the Directive 2000/14/EC.

This product has been assessed to conform to the Directive 2000/14/EC by means of unit verification by TÜV Rheinland Product Safety GmbH.

	RLT30CESA	RBC30SESA
Measured sound power level [dB (A)]:	110.7	111.5
Guaranteed sound power level [dB (A)]:	112	113
Date of issuance:	11/2007	11/2007

Technical documents are kept by Homelite Far East Co., Ltd. 24/F, 388 Castle Peak Road, Tsuen Wan, N. T., Hong Kong.

Declared in 11/ 2007 by Homelite Far East Co., Ltd.

RYOBI TECHNOLOGIES (UK) LIMITED.

Medina House,
Fieldhouse Lane, Marlow,
Buckinghamshire,
SL7 1TB,
UNITED KINGDOM
Tel: + 44 (0) 1628 894400
Fax: + 44 (0) 1628 894401
Technical Helpline : + 44 (0) 800 389 0305

TECHTRONIC INDUSTRIES FRANCE SAS

Immeuble Le Grand Roissy
Z.A. du Gué - 35 rue de Guivry
77990 LE MESNIL AMELOT FRANCE
Phone: + 33(0)1 60 94 69 70
Fax: + 33(0)1 60 94 69 79

RYOBI BELGIUM

Avenue des Pâquerettes, 55
Zoning artisanal - bâtiment 5
B - 1410 Waterloo
BELGIQUE
Tel : + 32(0) 2357 8140
Fax : + 32(0) 2357 8149

TTI ITALIA SRL

Via Fratelli Gracchi, 39
20092 Cinisello Balsamo (MI)
Italia
Tel : + 39(0) 5923 8408
Fax : + 39(0) 5924 6960

TECHTRONIC INDUSTRIES IBERIA S.L

Av. De la Industria,52
Coslada – Madrid – España
Tel: 91 485 12 10

**TECHTRONIC INDUSTRIES SOUTH AFRICA
CO. (PTY) LTD**

P.O Box 83888, South Hills, Johannesburg, 2136
South Africa

TECHTRONIC INDUSTRIES (ASIA) CO., LTD.

24/F, CDW Building,
388 Castle Peak Road,
Tsuen Wan, Hong Kong.
Tel : + 852 2402 6888

RYOBI TECHNOLOGIES GMBH

Itterpark 4
D-40724 Hilden
DEUTSCHLAND
Tel: + 49 (0) 2103 2958-0
Fax: + 49 (0) 2103 2958-29

RYOBI TECHNOLOGIES GMBH

Vertriebsbüro Österreich
Schinitzgasse 13
A-8605 Kapfenberg
Tel.: + 43 (0) 3862 23590-0
Fax: + 43 (0) 3862 23590-25

TECHTRONIC INDUSTRIES AUSTRALIA PTY LIMITED.

Building B, Rosehill Industrial Estate,
3 Shirley Street,
Rosehill NSW 2142
AUSTRALIA
Tel: (02) 8892 1800 or 1300 361 505
Fax: 1800 807 993

TECHTRONIC INDUSTRIES (NZ) LIMITED.

27 Clemow Drive, Mt Wellington
PO Box 12-806, Penrose, Auckland
NEW ZEALAND
Tel: + 64 (0) 9 573 0230
Free Call: +64 0800 279 624
Fax: + 64 (0) 9 573 0231

A&M MIDDLE EAST FZCO

P.O.Box 61254
Jedel Ali, Dubai,
UNITED ARAB EMIRATES
Tel.: + 9714 8861399
Fax: + 9714 8861400

TECHTRONIC INDUSTRIES DENMARK APS

Stamholmen 147, 4.
DK-2650 Hvidovre
Denmark
Tlf 43 56 55 55, Fax 43 56 55 56
E-mail: kundeservice@tti-emea.com

TECHTRONIC INDUSTRIES NORWAY AS

Tlf.: 800 12 493, Faks: 800 12 492
E-mail: kundetjeneste@tti-emea.com

TECHTRONIC INDUSTRIES SWEDEN AB

Tel (+46) 08 24 60 30. fax (+46) 08 24 60 31.
E-mail: kundtjanst@tti-emea.com

TECHTRONIC INDUSTRIES FINLAND OY

Tel. 0800 1 09000, Fax 0800 1 09001
Email: asiakaspalvelu@tti-emea.com

Machine: **30cc String Trimmer / Brush Cutter**

Name of company: Homelite Far East Co., Ltd.
Address: 24/F, CDW Building,
388 Castle Peak Road,
Tsuen Wan, Hong Kong.

Type: **RLT30CESA / RBC30SESA**

Name/Title: Andrew Eyre
Vice President, Engineering
Signature: 